



## LarFlex Type 71 Rubber Check Valves

The Type 71 check valve is designed to bolt directly to existing flanges or new installations, flanges are drilled 150 standard. Other drilling standards such as: ANSI 250/300, British Standard 10, JIS and DIN as well as square flanges are also available upon request. It can be installed in either vertical or horizontal applications.



### Flowrox “Chemical to Elastomer Guide”

Flowrox style number	Cover elastomer	Tube Elastomer	Max. Operating Temp °F (°C)		Branding Label Color	F.S.A. Material Class
71/BB	Chlorobutyl	Chlorobutyl	250°	(121°)	Black	STD. III
71/EE	EPDM	EPDM	250°	(121°)	Red	STD. III
71/NH	Neoprene	Hypalon®	212°	(100°)	Green	STD. II
71/NN	Neoprene	Neoprene	225°	(107°)	Blue	STD. II
71/PP	Nitrile	Nitrile	212°	(100°)	Yellow	STD. II
71/NV	Neoprene	Viton®	225°	(107°)	Orange	STD. III

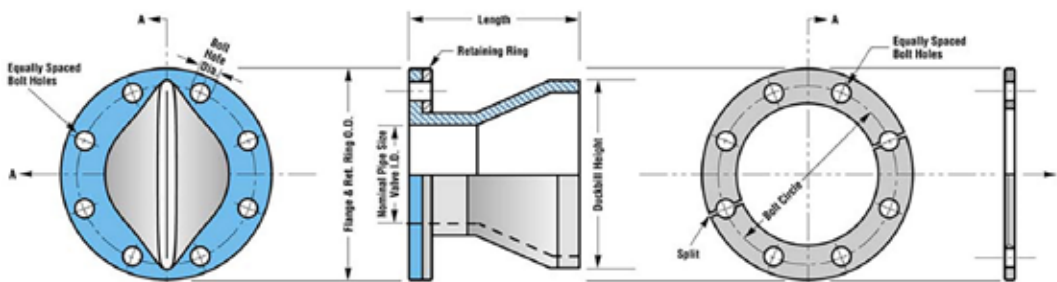

### Technical Details:

- All rubber construction resists abrasive slurries.
- NSF 61 is standard construction
- Very quiet operation with no water hammer
- Unique design prevents backflow
- Negligible maintenance and energy costs
- Will not warp or freeze
- Quick interchange with any flap type check valve.
- Available in sizes 1” - 96”

## Standard Dimensions for Type 71

Normal Pipe Size IN (amm)	Standard Dimensions		Standard Drilling				Weight LBS (kgs)
	Length IN (mm)	Duckbill Heigh IN (mm)	Flange O.D IN (mm)	Bolt circle IN (mm)	No. of Holes	Size of Holes IN (mm)	
1 (25)	4 (102)	2.125 (54)	4.25 (107.95)	3.13 (79.5)	4	.625 (15.9)	3 (1.4)
1.5 (40)	5 (127)	2.625 (67)	5 (127)	3.88 (98.55)	4	.625 (15.9)	4 (1.8)
2 (50)	6.5 (165)	3.875 (99)	6 (152.4)	4.75 (120.65)	4	.75 (19.1)	6 (2.7)
2.5 (65)	7.5 (191)	4.625 (118)	7 (177.8)	5.5 (139.7)	4	.75 (19.1)	8(3.6)
3 (80)	8.5 (216)	5.5 (140)	7.5 (190.5)	6 (152.4)	4	.75 (19.1)	10 (4.5)
4 (100)	10 (254)	7.375 (188)	9 (228.6)	7.5 (190.5)	8	.75 (19.1)	14 (6.4)
5 (125)	12 (305)	8.75 (223)	10 (254)	8.5 (215.9)	8	.875 (22.2)	17 (7.7)
6 (150)	13 (330)	10.5 (267)	11 (279.4)	9.5 (241.3)	8	.875 (22.2)	22 (10)
8 (200)	15 (381)	13.75 (350)	13.5 (342.9)	11.75 (298.45)	8	.875 (22.2)	27 (12.2)
10 (250)	17 (432)	17 (432)	16 (406.4)	14.25 (361.95)	12	1 (25.4)	39 (17.7)
12 (300)	19 (483)	19.625 (499)	19 (482.6)	17 (431.8)	12	1.125 (28.6)	62 (28.1)
14 (350)	21 (533)	24.75 (629)	21 (533.4)	18.75 (476.25)	12	1.125 (28.6)	81 (36.7)
16 (400)	24 (610)	26.5 (674)	23.5 (596.9)	21.25 (539.75)	16	1.25 (31.8)	125 (56.7)
18 (450)	26 (661)	29.75(756)	25 (635)	22.75 (577.85)	16	1.125 (31.8)	210 (95.3)
20 (500)	32 (813)	31.5 (801)	27.5 (698.5)	25 (635)	20	1.375 (34.9)	312 (141.5)
24 (600)	42 (1067)	43 (1093)	32 (812.8)	29.5 (749.3)	20	1.375 (34.9)	410 (186)
28 (700)	45 (1143)	46 (1169)	36.5 (927.1)	34 (863.6)	28	1.625 (41.3)	483 (219.1)
30 (750)	47 (1194)	49 (1245)	38.75 (984.25)	36 (914.4)	28	1.625 (41.3)	555 (251.7)
32 (800)	53 (1346)	51 (1296)	41.75 (1060.45)	38.5 (977.9)	28	1.625 (41.3)	605 (274.4)
36 (900)	58 (1473)	55.25 (1404)	46 (1168.4)	42.75 (1085.85)	32	1.625 (41.3)	665 (301.6)
42 (1050)	62 (1575)	66.25 (1683)	53 (1346.2)	49.5 (1257.3)	36	2 (50.8)	965 (437.7)
48 (1350)	72 (1829)	74.5 (1893)	59.5 (1511.3)	56 (1422.4)	44	2 (50.8)	1005 (455.9)
54 (1350)	74 (1880)	78.25 (1988)	66.25 (1682.75)	62.75 (1593.85)	44	2 (50.8)	1085 (492.1)
60 (1500)	82 (2083)	85 (2159)	73 (1854.2)	69.25 (1758.95)	52	2 (50.8)	1285 (582.9)
72 (1800)	98 (2489)	105 (2667)	86.5 (2197.1)	82.5 (2095.5)	60	2 (50.8)	1500 (680.4)

Larger sizes available upon request.  
Weights are approximate.



Flowrox, INC.  
808 Barkwood Ct Suite N  
Linthicum, MD 21090  
Tel. 410.636.2250

[www.flowrox.com](http://www.flowrox.com)  
[info@flowrox.com](mailto:info@flowrox.com)

