

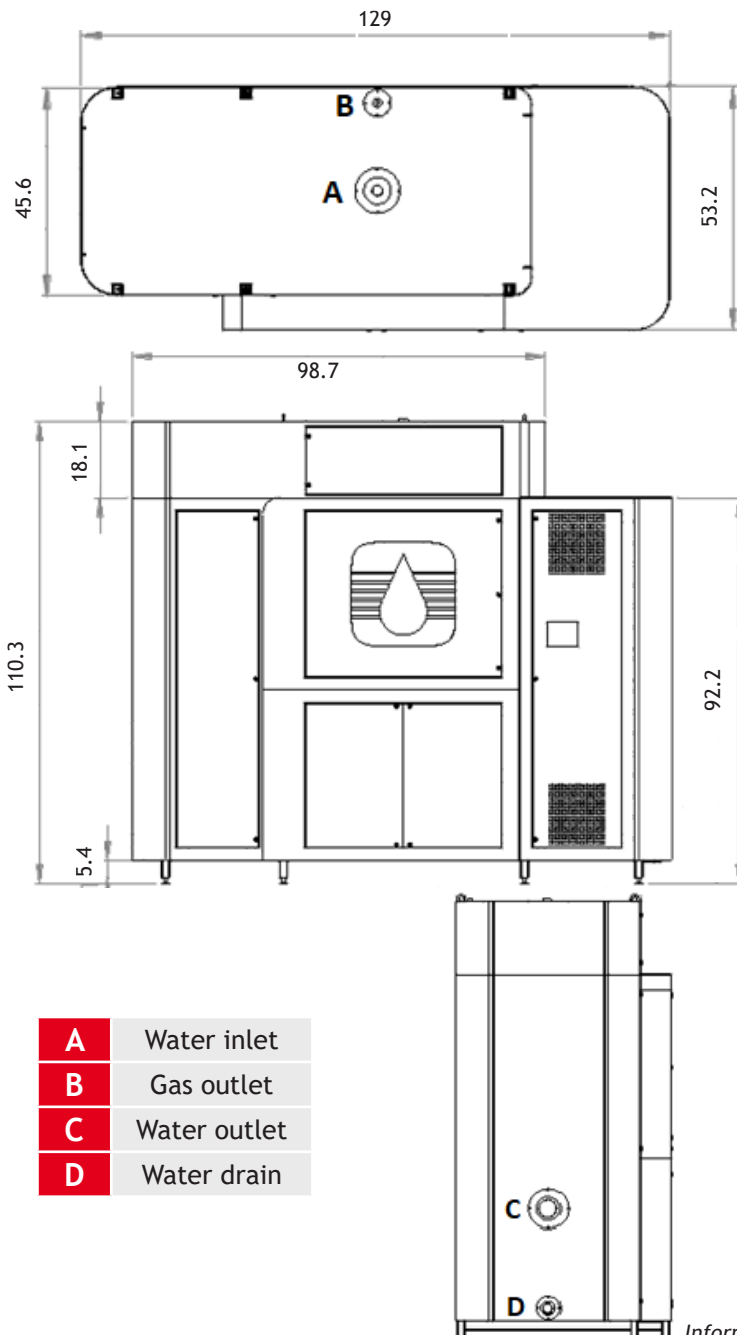

Flowrox Plasma Oxidizer™

Main dimensions (inches)



- A** Water inlet
- B** Gas outlet
- C** Water outlet
- D** Water drain

Technical Data

Net weight	4200 lb
Shipping weight	6600 lb
Gross weight	7700 lb
Water tank volume	330 g
Volumetric capacity	264–6604 gph
Input power	~3.5 kW
Nominal plasma power	2.0 kW
Voltage / frequency	400 V / 50 Hz 3 phase 32 A, other standards available
Water inlet	R2" male thread
Water outlet	R4" male thread
Water drain	R2" male thread
Gas outlet	3/8"
Gas inlet (optional O2 generator)	3/8" twin port
Min. & max. ambient temp.	33.8 °F – 86 °F
Min. & max. water temp.	33.8 °F – 95 °F
Inputs	24 V DC for remote operation
Outputs	230 VAC relays indicating system operation & alarms
Materials in contact with water	AISI 316, PEEK

Information without engagement. All rights to changes without prior notice reserved.

